



TABLE OF CONTENTS

2010–2011 BOARD OF DIRECTORS	PAGE 2
PRESIDENT'S WELCOME	PAGE 3
CONFERENCE SCHEDULE AT-A-GLANCE	PAGE 4
MAP OF CONFERENCE ROOMS	PAGE 6
DETAILED CONFERENCE SCHEDULE	PAGE 7
ABOUT IFPE	PAGE 25
IFPE PRESIDENTS	PAGE 27
HANS W. LOEWALD MEMORIAL AWARDEES	PAGE 28
DISTINGUISHED EDUCATOR AWARDEES	PAGE 29
INDIVIDUAL MEMBERS (ALPHABETICALLY)	PAGE 30
INDIVIDUAL MEMBERS (GEOGRAPHICALLY)	PAGE 42
ORGANIZATIONAL MEMBERS (ALPHABETICALLY)	PAGE 45
PRESENTERS' BIOGRAPHIES (ALPHABETICALLY BY PRESENTER)	PAGE 52

COVER IMAGE: "WRAPPING IT UP AT THE LAFAYETTE," 1974

ART © ROMARE BEARDEN FOUNDATION/LICENSED BY VAGA, NEW YORK, NY

2010-2011 IFPE BOARD OF DIRECTORS

OFFICERS

DOUGLAS F. MAXWELL, *PRESIDENT*
STUART SPENCE, *TREASURER*

PAULA SHATSKY, *SECRETARY*
JAY SWANSON, *PARLIAMENTARIAN*

2010 MEMBERS-AT-LARGE

SAMOAN BARISH
BILLY BRENNAN
PAUL COOPER

LARRY GREEN
MERLE MOLOFSKY
RACHEL NEWCOMBE

RICHARD RAUBOLT
JUDITH E. VIDA

2011 MEMBERS-AT-LARGE

SAMOAN BARISH
BILLY BRENNAN
CHRISTINA GRIFFIN

MERLE MOLOFSKY
RACHEL NEWCOMBE
RICHARD RAUBOLT

HARVEY SIEGEL
JUDITH E. VIDA

STANDING COMMITTEE CHAIRS

Membership:

Judith E. Vida

Conference 2010:

BILLY BRENNAN
STEVEN KUCHUCK
SARA LAVNER
MERLE MOLOFSKY
RICHARD RAUBOLT
PAULA SHATSKY

Finance:

Stuart Spence

Publications Committee:

Richard Raubolt

Elections:

Jay Swanson

AD HOC COMMITTEE CHAIRS

Awards:

Samoan Barish

History of Psychoanalysis:

BILLY BRENNAN (Co-Chair)
CHRISTINA GRIFFIN (Co-Chair)

Psychoanalysis and Ethics:

Merle Molofsky

Psychoanalytic Research:

V. Barry Dauphin

Social Responsibility

Farrell Silverberg

Spirituality and The Psyche:

Paul Cooper

Women and Psychoanalysis

Karen Morris

MESSAGE FROM THE PRESIDENT

Welcome to the 21st Annual IFPE Conference: *Psychoanalysis, Not the Same Old Song and Dance?* This year the conference has been planned and accomplished by a committee made up of both IFPE members and board members. I would like to thank all of them, but especially Billy Brennan, Paula Shatsky and Steve Kuchuck who did the lion's share of organizing and arranging the schedule of presentations. Also Merle Molofsky and Richard Raubolt for their work on preparing the call for participation, and Sara Lavner who has volunteered much of her time to help with the arrangements for the gala and the other extracurricular events. Finally, thanks to our Administrator, Linda Schultz, who has worked diligently to make the conference flow with the resonance it deserves.

Now, put on your dancing shoes, tune up your voice and indulge in pure IFPE melody during the next three days as you immerse yourself in the conference. I will too.

Douglas F. Maxwell
IFPE President

CONFERENCE SCHEDULE AT-A-GLANCE

FRIDAY, OCTOBER 29, 2010 - WILLIS CONFERENCE CENTER

8:00 AM TO 5:00 PM	REGISTRATION (Willis Conference Center near Refreshment Center)			
8:20 AM TO 8:50 AM	Welcome & Introduction: Douglas F. Maxwell (Willis Amphitheatre)			
8:50 AM TO 9:00 AM	BREAK			
	Willis - Room 110	Willis - 104 A	Willis - 104 B	Willis - Amphitheatre
9:00 AM TO 9:50 PM	Dream Imagery, Personal Symbology and a Note on the Tarot	Psychoanalysis: The Oldest Chant and Ritual	The Deadening Silence of Suicide	Trauma and Forgiveness: Advancing the Conversation
PRESENTER(S)	Leanne Domash	Farrell Silverberg	Caroline de Pottél	Richard Raubolt
Moderator	B. William Brennan	Susan Thau	Jon Mills	Katherine Schwarzenbach
9:50 AM TO 10:00 AM	BREAK			
10:00 AM TO 11:50 AM	ETHICS and SOCIAL RESPONSIBILITY PANEL - Reality Touches the World: Psychoanalysis and the Social-Political Unconscious	Exploring the Music of the Clinical Hour		Cross-Cultural Perspectives on Psychoanalytic Research
PRESENTER(S)	William MacGillivray, Leanh Nguyen and Alan Roland	Marilyn McCabe, John T. Sloma and Susan Thau		Barry Dauphin, Alexandra Freches Duque and Karola Mostafanejad
Moderator	Merle Molofsky and Farrell Silverberg	Judith E. Vida		Cecile Generaux Schwedes
11:50 AM TO 1:10PM	COMPLIMENTARY LUNCH (in the Atrium of the Willis Conference Center)			
1:10 PM TO 2:50 PM	Into the Future: Technology + the Psyche	The Song and Dance That Psychoanalysis REALLY Is - Utilizing Drama and Music Therapy		Thinking about Clothes: Not for Women Only
PRESENTER(S)	Christina Griffin and Erica L. Hill	Sara Lavner and Janet Sullivan		Samoan Barish and JoAnn Culbert-Koehn
Moderator	Tom Archbald	Lynn Somerstein		Paula Shatsky
2:50 PM TO 3:00 PM	BREAK			
3:00 PM TO 4:50 PM	Interrogating Interpretation	The Old Song: Trauma and Loss. The New Song: Survival		Psychoanalytic Education in a New Key
PRESENTER(S)	Jon Mills and Julius Seeman	Fang Duan and Ruth Litjmaer		Phillip Bennett, Mary Dougherty and Stefanie Teitelbaum
Moderator	Larry Green	Sally Bjorklund		Richard Raubolt
4:50 PM TO 5:00 PM	BREAK			
5:00 TO 5:50 PM	Gravity of the Black Hole	From Fragmentation to Integration		This Is What Psychoanalysis Looks Like
PRESENTER(S)	Fred Feirstein	Mildred Antonelli		Sally Bjorklund
Moderator	Merle Molofsky	Susan Neelley		Joel Miller
5:50 PM TO 6:00 PM	BREAK			
6:00 PM TO 6:45 PM	President's Address & Annual Membership Meeting: Douglas F. Maxwell <i>The Same Old Song and Dance: Reflections on the Psychoanalytic Political Landscape</i> (Willis Amphitheatre)			
7:15 PM	No-Host Cocktails and Complimentary Hors D'oeuvres (Sheraton Music City Hotel)			

SATURDAY, OCTOBER 30, 2010 - SHERATON MUSIC CITY HOTEL

8:00 AM TO NOON				
REGISTRATION (McGavock's Ballroom Foyer)				
	McGavock A	McGavock B	McGavock C	Evergreen
8:30 AM TO 9:20 PM	Two in a Room, Together: Yoga Breathing and Psychotherapy Alleviate Anxiety	Riffing with the Unconscious: An Experiment	Macmurray's Philosophy of Community and Psychoanalysis	General Psychoanalytic Field Theory: Its Structure and Applications to Psychoanalytic Perspectives
PRESENTER(S)	Lynn Somerstein	Gail R. Yardley	Ryan LaMothe	Montana Katz
Moderator	Jay Swanson	Judith E. Vida	Phillip Bennett	Tom Archbald
9:20 AM TO 9:30 AM BREAK				
9:30 AM TO 11:20 AM	SPIRITUALITY & THE PSYCHE PANEL - Intuition, Thinking & Being: Speaking the Ineffable	Inside the Autobiographical Dialogue: A Conversation	Reflections on the Frame: Reimagining the Psychoanalytic Surround for an Expanded Scope of Practice	Many Streams That Make A River: Passions and Practices That Inform Our Work
PRESENTER(S)	Volney Gay and Marilyn Stickle	Gerhson J. Molad and Judith E. Vida	Tamara McClintock Greenberg, Bart Magee and Dai To	Eugene Alexander and Merle Molofsky
Moderator	Elaine Silberman	Christina Griffin	Katherine Knowlton	Les Von Losberg
11:20 AM TO 11:30 AM BREAK				
11:30 AM TO 12:20 AM	Decoding Ferenczi's Clinical Diary: Biographical Notes on Identities Concealed and Revealed	The Patient Has No Past—and Other Revisions from a Phenomenological Perspective	Transexual Surgery: A Novel Reminder and a Navel Remainder	The Emotional Challenges of Family Life: A Psychoanalytic Perspective
PRESENTER(S)	B. William Brennan	Vance R. Sherwood	Oren Gozlan	Loren Buckner
Moderator	Larry Green	V. Barry Dauphin	Douglas Maxwell	Johanna Cuevas
12:20 PM TO 1:45 PM LUNCH				
1:45 PM TO 2:35 PM	Descent into Paradise: Michael Jackson and the Christ Feeling	HISTORY PRESENTATION - From Elasticity to the Confusion of Tongues: A Historical Commentary on the Technical Dimension of the Freud-Ferenczi Controversy	Not Your Daddy's Murder Ballad	The "Noah's Ark" Boy: A Case Study
PRESENTER(S)	Josie Oppenheim	Peter T. Hoffer	Les Von Losberg	Maria do Rosário Dias
Moderator	Paula Shatsky	B. William Brennan and Christina Griffin	Sara Lavner	Janet Sullivan
2:35 PM TO 2:45 PM BREAK				
2:45 PM TO 4:35 PM	The Quantum Leap for Psychoanalysis	WOMEN & PSYCHOANALYSIS PANEL - Views Into Identity	Resilience + Resistance + What It Takes to Survive	The Relationship Between Analyst and Psychopharmacologist: A Match Made in Heaven?
PRESENTER(S)	Douglas Maxwell (for Gerald J. Gargiulo) and Ken Silvestro	Elizabeth Lunbeck and Cecile Generaux Schwedes	Johanna Cuevas and Peggy DuBois	Meryle Gellman and Nicole Poliquin
Moderator	Susan Thau	Samoan Barish	Bonnie Saland	Joel Miller
4:35 PM TO 5:15 PM BREAK				
5:15 PM TO 7:00 PM	2010 Distinguished Educator Awards: Volney Gay, Elizabeth Lunbeck, William MacGillivray 2010 Hans W. Loewald Memorial Award & Address: Judith Viorst (McGavock Ballroom A)			
8:00 PM	Gala Dinner - by separate subscription (McGavock Ballroom B)			

SUNDAY, OCTOBER 31, 2010 - SHERATON MUSIC CITY HOTEL

8:00 AM TO 9:00 AM				
"Books & Bagels" - Book Sales and Complimentary Continental Breakfast (McGavock B)				
	McGavock A	McGavock B	McGavock C	Evergreen
9:00 AM TO 9:50 AM	Sexual Transference in Music Therapy at the End of Life: A Case Study		Psychoanalytic Ideas for Everyday Living: Teaching the General Public	Teaching in the Trenches: Psychoanalysis in Undergraduate Psychology.
PRESENTER(S)	Meghan Hinman		Ruth Neubauer	Koby Frances
Moderator	Lynn Somerstein		Susan Neelley	V. Barry Dauphin
9:50 AM TO 10:00 AM BREAK				
10:00 AM TO 11:50 AM	Healing Mental Health through Pursuit of Passion		The Balint Group: Definition, Experiential Introduction and Uses	Drawing on the Self + Other
PRESENTER(S)	Porter Smith, Rita Coufal and Thomas Robatham		Katherine Knowlton	Stuart D. Perلمان and Rachel Ryan
Moderator	Sarah Chianese		B. William Brennan	Douglas Maxwell
11:50 AM TO NOON BREAK				
NOON - 12:30 PM Conference Wrap-Up (McGavock A)				

WILLIS CONFERENCE CENTER FLOOR PLAN (FRIDAY)

SHUTTLE AVAILABLE FROM HOTEL TO CONFERENCE CENTER

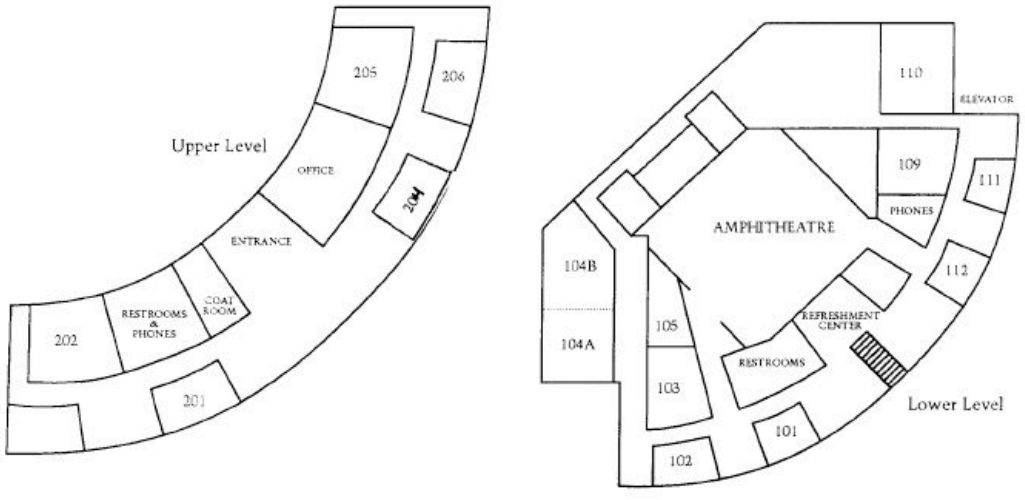

SHERATON MUSIC CITY HOTEL FLOOR PLAN (SATURDAY & SUNDAY)

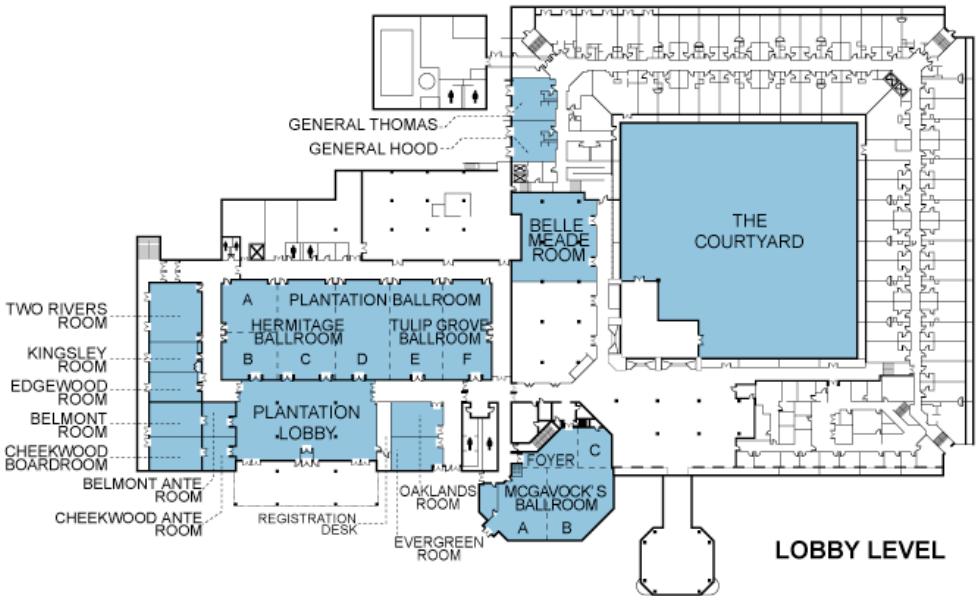

CONFERENCE SCHEDULE

THURSDAY 10/28, 8:00 – 11:00 PM

PRE-CONFERENCE MUSIC NIGHT (by subscription)

Location: Meet in Lobby of Sheraton Music City Hotel

FRIDAY, 10/29, 8:00 AM – 5:00 PM: REGISTRATION

Location: Willis Conference Center

FRIDAY, 10/29, 8:20– 8:50 AM: WELCOME AND INTRODUCTION

Room: Willis Amphitheatre

Presenter: Douglas F Maxwell (NY), IFPE President

FRIDAY, 10/29, 8:50 – 9:00 AM: BREAK

FRIDAY, 10/29, 9:00 – 9:50 AM: FOUR CONCURRENT PRESENTATIONS

Presentation: Dream Imagery, Personal Symbology and a Note on the Tarot

Room: Willis 110

Presenter: Leanne Domash (NY)

Visual images in dreams are powerful informants of the patient's past, present and possible future. Patient and therapist can use these symbols, much as querent, and reader can use the Tarot, to develop a co-constructed, meaningful narrative. However, rather than the universal symbols of the Tarot, the patient's personal symbology is used.

Moderator: B. William Brennan (RI)

Presentation: Psychoanalysis: The Oldest Chant and Ritual

Room: Willis 104 A

Presenter: Farrell Silverberg (PA)

Psychoanalysis has a lifeline that dates back to the oldest shamanic rituals and wisdom. Our ghosts may have newer names, like introjects and neuroses, and our empathic rituals don't involve switching clothes with the patient and doing a dance. But our ways of working are metaphorically similar. This presentation drawing lines between ancient wisdom and today's psychoanalysis.

Moderator: Susan Thau (CA)

Presentation: The Deadening Silence of Suicide

Room: Willis 104 B

Presenter: Caroline de Pottél (CA)

The author shares her personal account of patient suicide and recovery. Parallels are drawn between the deadening silence of the suicidal event and the silence within the professional community. She discusses the tormenting anguish leading up to the suicide, the shock of the actual event, as well as the aftermath of personal isolation within her psychoanalytic community.

Moderator: Jon Mills (Ontario, Canada)

Presentation: Trauma and Forgiveness: Advancing the Conversation

Room: Willis Amphitheatre

Presenter: Richard Raubolt (MI)

My presentation will begin with a brief clinical vignette of “psychic theater.” This story, Weightlessness, will focus on severe, complex trauma and the ensuing complexities of forgiveness. The audience will be invited to join in a conversation elicited by a series of prepared questions to explore the role of forgiveness in psychoanalytic practice. Exchange, debate, dialogue and clinical discussion are welcomed.

Moderator: Katherine Schwarzenbach (CA)

FRIDAY, 10/ 29, 9:50 – 10:00 AM: BREAK

FRIDAY, 10/ 29, 10:00 – 11:50 AM: THREE CONCURRENT PANELS

Presentation: ETHICS and SOCIAL RESPONSIBILITY PANEL – Reality Touches the World: Psychoanalysis and the Social–Political Unconscious

Room: Willis 110

Presenter: William MacGillivray (TN)

Politics of the Unconscious: Psychoanalytic Perspectives on Culture and Political Action

Throughout the 1920s and 1930s, many psychoanalysts were deeply involved in political action and promoting cultural change. Increasingly, organized psychoanalysis became unwilling to address the need for political and cultural engagement. I will review this history and survey recent attempts to address politics and culture from a psychoanalytic perspective.

Presenter: Leanh Nguyen (NY)

Psychoanalysis and Human Rights: The Clinical, the Political, and the Personal

Through a description of the psychic injuries in torture victims and the demands that these pose, the author argues that the clinician makes contact with her own history and existential questions in the work with trauma victims. Reflections on psychoanalysis as a political–ethical tool and safeguard of human rights are offered.

Presenter: Alan Roland (NY)

The Interface of Politics and Paranoia: The Political Exploitation of Paranoid Anxiety

This is an interdisciplinary paper that relates politics and paranoia on individual and sociopolitical levels. Individual paranoia is related to vulnerability and weakness, sociopolitical paranoia to domination and exploitation. They interface with each other through omnipotent fantasies, and heightened splitting and vulnerability to expectations of others in groups.

Moderators: Merle Molofsky (NY) and Farrell Silverberg (PA)

Presentation: Exploring the Music of the Clinical Hour

Room: Willis 104 A

Presenter: Marilyn McCabe (TN)

The Play's the Thing: Narrative Beyond Plot in Psychoanalytic Psychotherapy

Attunement to narrative as play helps us respond reciprocally to experience that is inchoate or subsymbolic. Narrative structuring includes creative play such as sound, pitch, cadence, nonverbal action, and use of objects. Collaborative development of narrative may have greater significance to the patient than the realization of the plot.

Presenter: John T. Sloma (NY)

The Rhythms of Psychoanalysis and the "Counterpoints" of Therapeutic Spontaneity

Integrating psychoanalytic perspectives with the everyday rhythms of "common sense" may yield a unique "music" for the process of treatment sessions. This presentation will demonstrate the integration of therapeutic "spontaneity" and common sense with the expectations of psychoanalytic "rigor."

Presenter: Susan Thau (CA)

The Music of Relating: Harmony and Disharmony, Concordance and Discordance

Our relationships, like jazz improvisations, are always in the process of flux and change. Each sequence leads to the possibility of harmony or the cacophony of discordance, but the dynamic of the relationship is based on the constancy of change. This paper focuses on the neuropsychobiology of interpersonal change as well as the mechanisms of relational repair.

Moderator: Judith E. Vida (CA)

Presentation: Cross-Cultural Perspectives on Psychoanalytic Research

Room: Willis Amphitheatre

Presenter: V. Barry Dauphin (MI)

The same lyrics and singer, but a different melody

A single narrative of a psychoanalytic session was dramatized and recorded in two different versions. Two groups of psychoanalytic practitioners each listened to one version and rated the patient, intervention strategies and countertransference reactions. Sara Pouliot, Ph.D. and Stacey Nefouse, M.A. contributed to this project.

Presenter: Alexandra Freches Duque (Portugal)

“MENS SANA IN CORPORE SANO”: The Concept of Health and Illness in Childhood

The graphic representation of thoughts using drawings is one of the most ancient resources of human communication, and a privileged means of communication with the child. In this work, we aim to understand the meaning of the concept of health and illness in school children, performing a subsequent psychoanalytic interpretation of the collected drawings.

Presenter: Karola Mostafanejad (Australia)

The Way Forward for Psychoanalysis

People diagnosed with a mental disorder identified how psychoanalysis can lead the way forward in mental health care. They explained how they were disempowered by society, which led to their life being a daily struggle. To make a lasting difference, psychoanalysis has to broaden its field and advocate for a change in the power relationship between them and society.

Moderator: Cecile Generaux Schwedes (CA)

FRIDAY, 10/ 29, 11:50 AM – 1:10 PM: LUNCH

Lunch compliments of the Sheraton Music City Hotel

Location: Atrium, Willis Conference Center

FRIDAY, 10/ 29, 1:10 – 2:50 PM: THREE CONCURRENT PANELS

Presentation: Into the Future: Technology + the Psyche

Room: Willis 110

Presenter: Christina Griffin (CA)

No More “Away”: Techno-attachments and the Relational Future

This paper speculates about the impact of techno-connectedness on our children, ourselves, our grandchildren. Triggered by recollections from Victorian novels which describe European summers “away” from home, a concern about loss of opportunity, the “space” for self-discovery in this young generation will be explored in a relational context. Brought about by pervasive dependence upon techno-connectedness, is self-experience fragmented by the illusion of multi-tasking benefits and is the more isolated, reflective experience being eroded?

Presenter: Erica L. Hill (FL)

From Umbilical to USB: Should the Analyst Use Technology to Aid Attachment in Therapy?

Technology is the medium of today’s youth. Face-to-face relationships and handshakes have been replaced with computers, iphones, and ipods. This presentation addresses how technology can be creatively incorporated into contemporary analytic treatment to promote healthy attachment and as a means of intervention and assessment. Specific case vignettes will be discussed.

Moderator: Tom Archbald (CA)

Presentation: The Song and Dance That Psychoanalysis REALLY Is – Utilizing Drama and Music Therapy

Room: Willis 104 A

Presenters: Sara Lavner (NY) and Janet Sullivan (NY)

Psychoanalysis has elements of song and dance via gesture, dream, pace, rhythm and tone. This experiential workshop reveals the unconscious communication between patient and analyst through role-play and music, utilizing case materials of the attendees. Non-verbal communications are an important part of the bedrock of both psychoanalysis and the creative arts therapies.

Moderator: Lynn Somerstein (NY)

Presentation: Thinking about Clothes: Not for Women Only

Room: Willis Amphitheatre

Presenters: Samoan Barish (CA) and JoAnn Culbert-Koehn (CA)

Do you think about clothes? When do you think about clothes? How did you develop your own sense of style or did you? How do clothes come up in analysis? Or do they? What experience can you share with us? Please join a lively discussion thinking about clothes.

Moderator: Paula Shatsky (CA)

FRIDAY, 10/ 29, 2:50 – 3:00 PM: BREAK

FRIDAY, 10/ 29, 3:00 – 4:50 PM: THREE CONCURRENT PANELS

Presentation: Interrogating Interpretation

Room: Willis 110

Presenter: Jon Mills (ON, Canada)

Deconstructing Hermes: On the Hermeneutic Turn in Psychoanalysis

Today hermeneutics is broadly classified as the analysis or process of interpretation and the possibility of its conditions. The general or systematic fabric of language, and the particular acts of interpretation, therefore generate the semiotic conditions or ground for the possibility of all understanding. This is the postmodern platform for the linguistic turn in philosophy spearheaded by many German and French hermeneutic traditions, which has become increasingly favored in contemporary psychoanalytic discourse. Throughout this presentation, I will engage some inherent problematics that are associated with hermeneutic perspectives and suggest a conciliatory approach that suspends the hegemony of the science versus philosophical debate in psychoanalysis.

Presenter: Julius Seeman (TN)

Presentness and Interpretation: An Integration of Humanistic and Psychoanalytic Approaches to Psychotherapy

This presentation points to the resemblance and interrelatedness of experiential presentness in humanistic psychotherapy and interpretation as defined by Fenichel and Freud. I look at the contextual bases of these processes in the context of a long-term psychotherapy experience that was recorded and fully transcribed.

Moderator: Larry Green (CA)

Presentation: The Old Song: Trauma and Loss. The New Song: Survival

Room: Willis 104 A

Presenter: Fang Duan (ON, Canada)

The “Father” as Surviving Agency – The Case of Louise Kehoe’s In This Dark House

In this paper I will use the conceptualization of ‘paternal function’ from psychoanalytical theory to offer a close-reading of In This Dark House, a memoir by Louise Kehoe, daughter of a Holocaust survivor. I will explore the importance of the paternal function, a third party between the child and his or her ‘natural objects,’ as a surviving agency that enables the child to walk out of the damaging effects of the wounded paternal objects and achieve healing, reconciliation, and sublimation.

Presenter: Ruth Litjmaer (NI)

Shared Trauma by Patient and Analyst: Countertransference Implications

This presentation explores countertransference feelings that the analyst had to face while dealing with a traumatic situation that paralleled the patient’s trauma. Special emphasis will be given to the struggles of the analyst about her internal state during this time as well as the tools she used to deal with both traumas and with other patients.

Moderator: Sally Bjorklund (WA)

Presentation: Psychoanalytic Education in a New Key

Room: Willis Amphitheatre

Presenter: Phillip Bennett (PA)

Trusting the Authentic Voice: Aliveness and Deadness in the Music of Psychoanalysis and Singing

Both the psychoanalyst and the singer use themselves as their primary instrument. Training can assist or constrict the music made by each. How is the authentic voice found and trusted so that aliveness is not stifled by mimicry and deadness? How can one avoid the “same old song and dance”? Clinical and vocal examples will be given.

Presenter: Mary Dougherty (IL)

Subjective Education in Analytic Training: Drawing on Values from the Art Academy

Kernberg observes that psychoanalytic education participates in the educational models of the art academy, trade school, religious seminary and university – and exists in an atmosphere of indoctrination rather than exploration. This paper will explore the art academy model for correspondences between artistic and analytic trainings focusing on the subjective education of psychoanalytic candidates.

Presenter: Stefanie Teitelbaum (NY)

Out-Of-Tune, Attunement and Atonement: A Psychoanalytic Duet

I am a trained opera singer and my father was tone-deaf. His monotone may have been attuned to himself. I explore the transformative interplay of my often critical musical ear with my father's pure monotone in my development as an analyst. I have formulated concepts of aural sadism, aural abjection and aural jouissance in the analytic duet.

Moderator: Richard Raubolt (MI)

FRIDAY, 10/ 29, 4:50 – 5:00 PM: BREAK

FRIDAY, 10/ 29, 5 – 5:50 PM: THREE CONCURRENT PRESENTATIONS

Presentation: Gravity of the Black Hole

Room: Willis 110

Presenter: Fred Feirstein (NY)

Gravity of the Black Hole is an expressionist verse/play poetic sequence in which I explicitly put together psychoanalysis and poetry. The first section is about the archetype Christ/Dionysius figure embodied in Freud who is persecuted by the Nazis, mostly told in a fairytale fashion. The play/book explores the origin of Nazism in child abuse and deception. The next three sections bring us into a psychoanalytically-based dramatization of the fairytale figures of Snow White, the Prince, the Witch, Hansel and Gretel, Cinderella, and Little Red Riding Hood.

Moderator: Merle Molofsky (NY)

Presentation: From Fragmentation to Integration

Room: Willis 104 A

Presenter: Mildred Antonelli (NY)

In practice Interpersonal Theory has tended to emphasize how we affect others. Self Psychology concerns itself mainly with our inner subjective experience. Integrating these two can lead to combining an enriched experience of the self with concern for others. Psychoanalysis could thus offer an alternative to the values of our current culture.

Moderator: Susan Neelley (WA)

Presentation: This Is What Psychoanalysis Looks Like

Room: Willis Amphitheatre

Presenter: Sally Bjorklund (WA)

Certain hard to reach patients take us out on a limb to find them. I propose some thoughts about how fundamental psychic work may proceed from the limb.

Moderator: Joel Miller (CA)

FRIDAY, 10/ 29, 5:50 – 6:00 PM: BREAK

FRIDAY, 10/ 29, 6:00 – 6:45 PM:

PRESIDENT’S ADDRESS & ANNUAL MEMBERSHIP MEETING
***“The Same Old Song and Dance: Reflections on the
Psychoanalytic Political Landscape”***

Douglas F Maxwell (NY), IFPE President

Room: Willis Ampitheatre

FRIDAY, 10/29, 7:15 PM

NO-HOST COCKTAILS & COMPLIMENTARY HORS D'OEURVES

Room: Sheraton Music City Hotel

SATURDAY, 10/30, 8:00 AM – NOON: REGISTRATION

Location: McGavock Ballroom Foyer

**SATURDAY, 10/30, 8:30 – 9:20 AM: FOUR CONCURRENT
PRESENTATIONS**

**Presentation: Two in a Room, Together: Yoga Breathing and Psychotherapy
Alleviate Anxiety**

Room: McGavock A

Presenter: Lynn Somerstein (NY)

This presentation is both clinical study and experiential workshop– I will present a case study showing the effects of talk therapy and breath work to alleviate anxiety and then teach one of the simple breathing techniques effective in regulating emotional reactions.

Moderator: Jay Swanson (NY)

Presentation: Riffing with the Unconscious: An Experiment

Room: McGavock B

Presenter: Gail R. Yardley (CA)

We will attempt a dialogue with the unconscious and find words to express the stirrings of this elusive phenomenon. The idea for the experiment germinated from teaching a Child Therapy seminar as we tried to find a way to catch the unconscious.

Moderator: Judith E. Vida (CA)

Presentation: Macmurray's Philosophy of Community and Psychoanalysis

Room: McGavock C

Presenter: Ryan LaMothe (IN)

Psychoanalytic anthropologies, in general, overlook the concept of community. Even recent inclusions of the concept of intersubjectivity do not clearly address the idea of community and its necessity in psychosocial development. John Macmurray's philosophy of community provides a perspective that adds to our understanding of parent-infant interactions, omnipotence, transference, and psychoanalytic goals.

Moderator: Phillip Bennett (PA)

Presentation: General Psychoanalytic Field Theory: Its Structure and Applications to Psychoanalytic Perspectives

Room: Evergreen

Presenter: Montana Katz (NY)

Various field concepts in psychoanalytic theory and practice are surveyed. In psychoanalytic field concepts there is not only a multiperspectival but also an international emergent psychoanalytic concept. From these concepts, a generalized notion of psychoanalytic field is described. With the generalized psychoanalytic field structure links between psychoanalytic perspectives are forged.

Moderator: Tom Archbald (CA)

SATURDAY, 10/ 30, 9:20 – 9:30 AM: BREAK

**SATURDAY, 10/ 30, 9:30 – 11:20 AM: FOUR CONCURRENT
PANELS**

**Presentation: SPIRITUALITY & THE PSYCHE PANEL – Intuition, Thinking & Being:
Speaking the Ineffable**

Room: McGavock A

Presenter: Volney Gay (TN)

I am a mystery to myself

We have divided minds. This makes judgment, planning, and neuroses possible. Because we can imagine diverse futures with diverse consequences we choose one action over another. To predict consequences, we tell a story about the future and then gauge our feelings to this imagined scene. To be neurotic is to tell (paranoid) stories that preclude learning; therapists supplant our neurotic stories—our idiosyncratic solution to the mystery of being a person—with better stories that make learning possible.

Presenter: Marilyn Stickle (VA)

Creative Listening: Treatment from the Perspective of Souls Having a Human Experience

Soul level awareness introduces a dimension of consciousness that opens doors to a path of meaning and purpose in our lives. Integration of understanding about connection that is shared by spiritual traditions, physics, and mind-body medicine informs analytic work that becomes heart to heart, intellect to intellect, and soul to soul.

Moderator: Elaine Silberman (CA)

Presentation: Inside the Autobiographical Dialogue: A Conversation

Room: McGavock B

Presenters: Gerhson J.Molad (Israel) and Judith E. Vida (CA)

Inside the Autobiographical Dialogue: A Conversation

A workshop in dialogue for newcomers and veterans of the Autobiographical Dialogue Seminar. Participants will reflect and discuss the practice of Autobiographical Dialogue: the professional and life-span development of their own voice, exploring the manner and difficulties in which autobiography (the way we present our life) and dialogue (the way we present our case) establish and influence theoretical and personal implications for clinical and conference work.

Moderator: Christina Griffin (CA)

Presentation: Reflections on the Frame: Reimagining the Psychoanalytic Surround for an Expanded Scope of Practice

Room: McGavock C

Presenter: Tamara McClintock Greenberg (CA), Bart Magee (CA) and Dai To (CA)

Reflections on the Frame: Reimagining the Psychoanalytic Surround for an Expanded Scope of Practice

Providing psychoanalytic treatment outside the traditional private practice setting requires a fresh look at theoretical conceptualizations and applications of the psychoanalytic frame. The panel participants discuss creative approaches to frame considerations in the analytic treatment of marginalized populations in diverse contexts— a hospital, a prison and a low-fee community clinic.

Moderator: Katherine Knowlton (WA)

Presentation: Many Streams That Make A River: Passions and Practices That Inform Our Work

Room: Evergreen

Presenters: Eugene Alexander (CA) and Merle Molofsky (NY)

Many Streams That Make A River: Passions and Practices That Inform Our Work

Over our many years of practice, like many other therapists, our work has been enriched and deepened by various other ‘practices’ from which we have imported language and metaphors, concepts and sensibilities. In this presentation we each track our involvement in other fields and describe our own journey of inclusion in regard to other practices that have informed our analytic work. Attendees to the workshop will be encouraged to share their own sources of inspiration from outside the field of psychotherapy.

Moderator: Les Von Losberg (NY)

SATURDAY, 10/ 30, 11:20 – 11:30 AM: BREAK

SATURDAY, 10/ 30, 11:30 – 12:20 AM: FOUR CONCURRENT PRESENTATIONS

Presentation: Decoding Ferenczi’s Clinical Diary: Biographical Notes on Identities Concealed and Revealed

Room: McGavock A

Presenter: B. William Brennan (RI)

In Ferenczi’s Clinical Diary certain codes are used to refer to patients. The identities of Dm and RN are known but the others have remained a mystery. I propose a working hypothesis of the code Ferenczi used and will reveal the identities and life stories of his other patients. I also discuss the ethics of writing psychoanalytic history.

Moderator: Larry Green (CA)

Presentation: The Patient Has No Past—and Other Revisions from a Phenomenological Perspective

Room: McGavock B

Presenter: Vance R. Sherwood (TN)

From Freud to object relations theory, psychoanalysis has relied on reductionistic metapsychologies. Many of our basic ideas could yield new fruit if seen from the standpoint of such thinkers as Husserl and Merleau-Ponty. This presentation takes a look at the concept of the patient's past, the repetition compulsion, and transference.

Moderator: V. Barry Dauphin (MI)

Presentation: Transexual Surgery: A Novel Reminder and a Navel Remainder

Room: McGavock C

Presenter: Oren Gozlan (ON, Canada)

This paper will attempt to offer a way to think about the ways in which transsexual phenomenon represents one way of struggling with the question of reading and being read and how this question relates to regulation of one's own pleasure.

Moderator: Douglas Maxwell (NY)

Presentation: The Emotional Challenges of Family Life: A Psychoanalytic Perspective

Room: Evergreen

Presenter: Loren Buckner (FL)

How can parents understand their children's feelings if they don't understand their own? Guilt, worry, sadness, anger and even hatred are emotions parents sometimes feel but are ashamed to talk about. Using the work of Winnicott, Klein, and McDougall, we'll explore the emotional and psychological challenges of raising children.

Moderator: Johanna Cuevas (CA)

SATURDAY, 10/30, 12:20 – 1:45 PM: LUNCH

Buffet lunch available for purchase in the hotel cafe.

SATURDAY, 10/30, 1:45 – 2:35 PM: FOUR CONCURRENT PRESENTATIONS

Presentation: Descent into Paradise: Michael Jackson and the Christ Feeling

Room: McGavock A

Presenter: Josie Oppenheim (NY)

Using Bion's observations of the group, I will explore how the most famous song and dance man in history, Michael Jackson, was felt to be a living god in our midst as well as the world's patient in need of our healing powers.

Moderator: Paula Shatsky (CA)

Presentation: HISTORY COMMITTEE – From Elasticity to the Confusion of Tongues: A Historical Commentary on the Technical Dimension of the Freud-Ferenczi Controversy

Room: McGavock B

Presenter: Peter T. Hoffer (PA)

Despite ongoing strain in their relationship, by 1931 Freud and Ferenczi were still in agreement regarding the technical innovations begun with Ferenczi's 1928 paper, "The Elasticity of Psychoanalytic Technique." New revelations by Ferenczi about his technique in October 1931, however, strongly influenced Freud's negative assessment of Ferenczi's "Confusion of Tongues" paper a year later.

Moderators: B. William Brennan (RI) and Christina Griffin (CA)

Presentation: Not Your Daddy's Murder Ballad

Room: McGavock C

Presenter: Les Von Losberg (NY)

The presentation will include a discussion of the characteristics of traditional murder ballads juxtaposed to contemporary murder ballads I have composed (and will sing) to highlight the manner and depth to which psychoanalysis has influenced aspects of our culture, both contemporary and traditional.

Moderator: Sara Lavner (NY)

Presentation: The "Noah's Ark" Boy: A Case Study

Room: Evergreen

Presenter: Maria do Rosário Dias (Portugal)

Peter is a teenage boy who was undergoing an adoption process. The presentation of this clinical case-study aims the illustration of how the recourse to therapeutic setting invariants – which included bringing to the session cages with small animals – represents a new symbolic order at the traditional psychoanalytic setting level.

Moderator: Janet Sullivan (NY)

SATURDAY, 10/ 30, 2:35 – 2:45 PM: BREAK

SATURDAY, 10/ 30, 2:45 – 4:35 PM: FOUR CONCURRENT PANELS

Presentation: The Quantum Leap for Psychoanalysis

Room: McGavock A

Presenter: Douglas Maxwell (NY) for Gerald J. Gargiulo (NY)

The Psychoanalytic Enterprise in a Quantum World – Playing with Ideas

The talk will focus on the role of theoretical models in psychoanalytic theory and how some of the models, introduced by Freud, have promoted a reification of psychoanalytic thinking. The discussion will introduce and explain some basic findings from quantum physics and show how they can aid in explicating clinical experience with particular reference to both conscious and unconscious experiences.

Presenter: Ken Silvestro (MT)

Newton Meets the Mad Hatter: Introducing Psychoanalysis to Quantum Physics

Discoveries in quantum physics turn our Newtonian reality upside down. Just as physicists are challenged to discover how the Newtonian and quantum realities integrate, so it is our challenge, as analysts, to uncover how our understanding of psyche, mind, psychoanalytic techniques and human development integrate with this strange reality in which body, soul, and spirit are unified.

Moderator: Susan Thau (CA)

Presentation: WOMEN & PSYCHOANALYSIS PANEL – Views Into Identity

Room: McGavock B

Presenter: Elizabeth Lunbeck (TN)

Joan Riviere and the Pleasures of Female Narcissism

Writing in the 1930s, the British psychoanalyst Joan Riviere argued for the pleasures of feminine narcissism, maintaining that the feminine fate that Freud could envision only in terms of lack, disappointment, and loss might better be characterized as offering its own satisfactions and narcissistic gratifications.

Presenter: Cecile Generaux Schwedes (CA)

A Dynamic Pairing of Self Psychology with Neuroscience and the Reframing of PMS

Focusing on a couple's therapy, this paper integrates the central role hormones play in punctuating memory and shaping the "future expected experience" of the other. Intertwined with the vignette, the subjectivity of neurobiology is examined and explained through the Self Psychological analytic perspective and illuminates the evolving interactional self object experiences for each of the partners.

Moderator: Samoan Barish

Presentation: Resilience + Resistance + What It Takes to Survive

Room: McGavock C

Presenter: Johanna Cuevas (CA)

When Resilience is interpreted as Resistance – Definitely Not the Same Old Song and Dance.
This presentation will explore the supposition that there is a time when resistance in therapy is actually a resilient behavior, and when recognized can enhance the therapeutic interaction. A personal anecdote, a clinical example, "The Diary of Anne Frank," and "Anne of Green Gables" are used to explore this supposition.

Presenter: Peggy DuBois (CA)

A Woman of Dependent Meanings

I will read to you blood letters. My mother commits to paper her thoughts and feelings about me, the second of her three daughters. As I share her signature language for me, you can witness the sounds of maternal triumph over extinguishing any tiny thread of possibility for her and I to share our lived history. These letters are declarations of practicing unthinkable maternal power: I, as subject, her daughter, cannot be. In my mother's world, I was permitted if I remained the same as her in thought, word and deed. That is the not I. Since these letters serve as evidence of my repeated experiences of personal annihilation, they are more precious than gold.

Moderator: Bonnie Saland (CA)

Presentation: The Relationship Between Analyst and Psychopharmacologist: A Match Made in Heaven?

Room: Evergreen

Presenters: Meryle Gellman (CA) and Nicole Poliquin (CA)

The Relationship Between Analyst and Psychopharmacologist: A Match Made in Heaven?
In this highly anxious time of economic survival, Drs. Poliquin and Gellman address the relationship between the psychopharmacologist and analyst. They bring together very different perspectives. Until now, there has been little documentation in the literature regarding a deep and mutual collaboration between the two practitioners on behalf of their shared patients. The process involving both professionals and the patient is highlighted in the presentation. They outline a protocol to insure a richer partnership.

Moderator: Joel Miller (CA)

SATURDAY, 10/ 30, 4:35 – 5:15 PM: BREAK

SATURDAY, 10/ 30, 5:15 – 7:00 PM

DISTINGUISHED EDUCATOR AWARDS

2010 Awardees: Volney Gay (TN), Elizabeth Lunbeck (TN), William MacGillivray (TN)

HANS W. LOEWALD MEMORIAL AWARD & ADDRESS

“LIFE LESSONS FROM UNDER EIGHT TILL ALMOST EIGHTY”

Judith Viorst (DC), 2010 Hans W. Loewald Memorial Awardee

Room: McGavock Ballroom A

SATURDAY, 10/ 30, 8:00 PM

GALA DINNER

by subscription

Room: McGavock Ballroom B

SUNDAY, 10/31, 8:00 – 9:00 AM: “BOOKS AND BAGELS”

Room: McGavock Ballroom B

Enjoy a complimentary continental breakfast and peruse/purchase books written or edited by presenters at this year’s IFPE Conference.

SUNDAY, 10/31, 9:00 – 9:50 AM: THREE CONCURRENT PRESENTATIONS

Presentation: Sexual Transference in Music Therapy at the End of Life: A Case Study

Room: McGavock A

Presenter: Meghan Hinman (NY)

Sexuality can be difficult to sit with when it enters the space between therapist and client in any setting. Explore sexual transference through the story of a young man whose complex journey to the end of life was affected by music therapy and his personal reactions to treatment.

Moderator: Lynn Somerstein (NY)

Presentation: Psychoanalytic Ideas for Everyday Living: Teaching the General Public

Room: McGavock C

Presenter: Ruth Neubauer (CO)

The core ideas of psychoanalytic theory are exceedingly rich in ideas and applicable to everyday living yet seemingly out of reach for the general public to understand. This presentation demonstrates an interdisciplinary, interactive method of teaching these basic concepts to the lay public to foster awareness and improve understanding.

Moderator: Susan Neelley (WA)

Presentation: Teaching in the Trenches: Psychoanalysis in Undergraduate Psychology.

Room: Evergreen

Presenter: Koby Frances (NY)

This talk will discuss psychoanalytic education in undergraduate psychology settings and will review specific pedagogical challenges and approaches. As undergraduate psychology education shapes the "psychological zeitgeist", this presentation will open up a space for both reflection and creative possibility concerning the role of psychoanalytic theory within these settings.

Moderator: V. Barry Dauphin (MI)

SUNDAY, 10/31, 9:50– 10:00 AM: BREAK

SUNDAY, 10/31, 10:00 – 11:50 AM: THREE CONCURRENT PANELS

Presentation: Healing Mental Health through Pursuit of Passion

Room: McGavock A

Presenters: Rita Coufal (CA), Thomas Robatham (MA) and Porter Smith (NY)

Rainlight Movement aims to provide hope, help, and inspiration for patients with bi-polar, or other mental health disorders, and their families. The objective of the Rainlight Project is to be a multi-media movement that voices the universal plight of mental illness, sharing its hope and its inspiration. Rainlight will attempt to lessen the stigma of experiences and diagnoses of the afflicted, while imparting the comfort and intellectual stimulation of collective, experiential art.

Discussant/Moderator: Sarah Chianese (NY)

Presentation: The Balint Group: Definition, Experiential Introduction and Uses

Room: McGavock C

Presenter: Katherine Knowlton (WA)

This introduction to Balint groups will: explain the format and effects of this psychoanalytic offshoot used in medical residencies and by practicing physicians world-wide; provide an opportunity to experience or observe a group; allow time for reflection/discussion. Participants may be asked to present brief case material. Prior experience unnecessary.

Moderator: B. William Brennan (RI)

Presentation: Drawing on the Self + Other

Room: Evergreen

Presenter: Stuart D. Perlman (CA)

Painting the Other's Soul: Psychoanalysis and Art

Painting a person's portrait can be similar to what happens in psychotherapy, and can shed light on how psychoanalysts utilize nonverbal cues. I will discuss several series of my paintings where each person is viewed/understood at different times; for example, a person who had a stroke and lost his ability to speak, and another person who became depressed.

Presenter: Rachel Ryan (TN)

Recovering the Self: Art Therapy as Self-Exploration in Substance Use Treatment

An art therapist presents her graduate thesis research on art for self-exploration by people in recovery from addictions. The significance of art therapy in a treatment setting is illuminated through the use of story and client artwork. Additionally, the art therapist describes her own parallel art practice with art images.

Moderator: Douglas Maxwell (NY)

SUNDAY, 10/ 31, 11:50 AM – NOON: BREAK

SUNDAY, 10/ 31, NOON – 1PM: PLENARY SESSION WRAP-UP

Room: McGavock Ballroom A

Please join us at this discussion session to share your experience of the weekend and to hear about IFPE future events.

SAVE THE DATE

22nd Annual IFPE Interdisciplinary Conference

“Return”

Lago Mar Resort

Fort Lauderdale, Florida

November 11–13, 2011

Please check www.IFPE.org for updates and additional information.

ABOUT INTERNATIONAL FORUM FOR PSYCHOANALYTIC EDUCATION

Contemporary psychoanalysis is characterized by a rich and creative pluralism in conceptualization and theory. Significant differences currently exist amongst the various theoretical and methodological positions that derive from the more contemporary orientations of: existential-humanistic, relational, transpersonal, philosophical, integrationist, and, hermeneutic psychologies – to name just a few. These various psychologies rest on different philosophical assumptions, premise different understandings as to the basic nature of people, posit different methods of knowing about people, and assume different purposes, objectives, and understandings for the analytic discourse. Psychoanalysis has been irreversibly altered by these different ways of seeing, knowing, and representing life, people, and reality as it is rethought, reinterpreted, and rewritten in the cultural context of the 21st century.

Founded in 1991, IFPE is an inclusive organization whose membership is open to anyone with a self-defined and proclaimed interest in the various discourses of psychoanalysis, such as clinical, academic, artistic, literary, or philosophical. The range of thinking that characterizes contemporary psychoanalysis has different perspectives in education, epistemology, ethics, and theory. These perspectives speak to the many equally meaningful interpretations of psychoanalytic discourse. IFPE provides the opportunity for interpretive encounters with these richly diverse and creative perspectives of the world, people, life, and psychoanalysis. A defining dimension of IFPE's uniqueness as an organization is its inclusiveness of this diversity of thinking, the threads of which are woven, at once, into the philosophical fabric of its governance structure and annual interdisciplinary conferences.

IFPE's annual conferences provide a space in the international forums of ideas in which participants have the opportunity to come forth and express their perspectives through discussion in a variety of different contexts, either formally in the panel and paper presentations or informally through other opportunities for interchange. Historically, the conference has been organized so as to provide the maximum opportunity for respectful, thoughtful and searching inquiry amongst the participants. IFPE's conference space is free of the restrictions imposed by certification and accreditation standards.

This freedom provides the maximum opportunity for discussions that mutually broaden our dialogue with other perspectives and disciplines and further psychoanalysis in its social and cultural understandings and applications.

IFPE seeks to create an alive space in the understanding of psychoanalysis in which each person can evolve. ...

Revised and adopted by the Board June 4, 2005

IFPE GOALS

1. Support the educational and training endeavors of psychoanalysts from different perspectives.
2. Encourage critical dialogue amongst representatives of those perspectives.
3. Promote research in the analytic domain.
4. Foster the teaching of psychoanalysis in undergraduate and graduate programs.
5. Articulate the equally meaningful theories, practices, and applications of psychoanalysis in the larger community.
6. Work collaboratively with other organizations in the space of our shared values.

MEMBERSHIP IN IFPE

To join or renew your membership in IFPE, please use the form found on our website at www.IFPE.org/members.html or contact the IFPE administrator at Admin@IFPE.org.

CHARITABLE DONATIONS TO IFPE

IFPE is a not-for-profit, charitable organization [501(c)(3)]. Donations are welcomed and greatly assist in the fulfillment of our stated goals. Donations are fully tax-deductible to the extent of the law. *To make a donation, please contact the IFPE administrator at Admin@IFPE.org.*

The General Fund

Such donations rest in the general accounts maintained for on-going operations of the organization. These important functions include payment to vendors for printing and postage of IFPE documents, conference related materials and so forth; the maintenance of the web-site; the many costs associated with putting together a yearly Professional Conference [hotel fees, audio-visual expenses, etc]; and much more.

The International Outreach Fund

Inaugurated in 2004, this fund has become a means of progressively working to truly situate 'internationalism' within all elements of the IFPE, per aspirational aspects of our mission. To date, donations have assisted IFPE in enabling international psychoanalytical scholars and practitioners in presenting at our conference, for whom cost would otherwise be prohibitive. We also envision a point at which the Fund may provide seed money for IFPE to consider the more financially challenging potentiality of hosting an IFPE Conference off the North American continent.

IFPE PRESIDENTS

JAMES BARRON, PH.D.	1993
MARGA SPEICHER, PH.D.	1994
STEPHEN FRIEDLANDER, PH.D.	1995
MARVIN HYMAN, PH.D.	1996
GERALD J. GARGIULO, PH.D.	1997
PATRICK B. KAVANAUGH, PH.D.	1998–1999
MICHAEL GUY THOMPSON, PH.D.	2000–2001
GERALD J. GARGIULO, PH.D.	2002
HAROLD B. DAVIS, PH.D.	2003–2004
JUDITH E. VIDA, M.D.	2005–2006
DAVID L. DOWNING, PH.D.	2007
DOUGLAS F. MAXWELL, LC, NCPSYA	2008 – PRESENT

HANS W. LOEWALD MEMORIAL AWARD

Hans W. Loewald (1906–1992) was a practitioner, scholar and teacher with a deep respect for the history and complexity of psychoanalytic thought. At the same time, he was an innovator who was not afraid to challenge prevailing wisdom and to extend the boundaries of our knowledge. His collected papers and his volume on psychoanalysis and the history of the individual endure as seminal explorations of psychoanalytic theory and process, creativity and culture. IFPE established the Hans W. Loewald Memorial Award in 1993 to recognize an individual's international stature "for original and outstanding contributions to the development of psychoanalytic theory, practice, and application."

Recipients of the Hans W. Loewald Memorial Award

Lawrence Friedman, M.D.	1993
Merton Gill, M.D.	1994
Jessica Benjamin, Ph.D.	1995
Peter L. Giovacchini, M.D.	1996
Stanley A. Leavy, M.D.	1997
Joyce McDougall, Ed.D.	1998
James S. Grotstein, M.D.	1999
John Gedo, M.D.	2000
Paul Roazen, Ph.D.	2001
Thomas Szasz, M.D.	2002
Dr. Andrew Samuels	2003
GIFRIC (<i>Groupe Interdisciplinaire Freudien des Recherche et d'Intervention Cliniques et Culturelles</i>)	2004
Ethel Spector Person, M.D.	2005
Christopher Bollas	2006
Mark Solms, M.D.	2007
Robert Jay Lifton, M.D.	2008
Michael Eigen, Ph.D.	2009
Judith Viorst	2010

DISTINGUISHED PSYCHOANALYTIC EDUCATOR AWARD

In 1998, IFPE inaugurated the Distinguished Psychoanalytic Educator Award for outstanding contributions to psychoanalytic education. Each year IFPE may choose to recognize several deserving recipients who have distinguished themselves in educating candidates and students of psychoanalysis in clinical and academic settings representing the broadest possible array of psychoanalytic knowledge.

1998

Martin Bergmann
Edgar A. Levenson, M.D.
William J. Richardson, Ph.D.

1999

John E. Beebe III , M.D.
Maureen Murphy, Ph.D.
Robert Wallerstein, M.D.

2000

Bertram Paul Karon, Ph.D.
Murray Stein, Ph.D.
Marian Tolpin, M.D.

2001

Robert C. Lane, Ph.D.
Peter L. Rudnytsky, Ph.D.
Antonio R. Virsida, Ph.D.

2002

Beverly Zabriskie, Ph.D.
Joseph Reppen, Ph.D.
Francesca Reppen

2004

Frank Summers, Ph.D.
Charles E. Turk, M.D.

2005

Donna Bentolila, Ph.D.
María Cristina Ríos Magalhães,
Ph.D.

2006

Jo Ann Culbert-Koehn LCSW
Arthur Malin, M.D.

2007

Deborah Britzman
Art Robbins, Ed.D.
Ronald Brent Willock

2008

Jaine L. Darwin, Psy.D.
John Muller, Ph.D.
Dena M. Reed, Ph.D.

2009

Margaret Crastnopol, Ph.D.
W. Ladson Hinton, M.D.
Karol Marshall, Ph.D.

2010

Volney Gay, Ph.D.
Elizabeth Lunbeck, Ph.D.
William MacGillivray, Ph.D.

IFPE MEMBERSHIP DIRECTORY
ORGANIZATIONAL MEMBERS (ALPHABETICALLY)

Autobiographical Dialogue Seminars

Contact: Judith Vida & Gershon Molad
8234 McGroarty Street
Sunland, CA 91040
Phone: 626-796-7572
Email: jvida@spence.net; moladgj@012.net.il

The Autobiographical Dialogue Seminars, founded in 2002, address the professional and life-span development of one's own voice in the dialogue between analysts. The seminars explore the manner and difficulties in which autobiography (the way we "write" our life) and dialogue (the way we present our case) establish and influence each other, as we experience and reflect -- along the Freudian-Ferenczian continuum -- on theoretical and personal implications for clinical work and conference presentation. For further information, contact Judith Vida and/or Gershon Molad.

Baltimore Psychotherapy Institute

Contact: Daniel Buccino
711 West 40th Street, Ste#456
Baltimore, MD 21211
Phone: 410-235-9200
Website: www.baltimorepsychotherapy.org

The Baltimore Psychotherapy Institute (BPI) is an international training and consultation group dedicated to producing accountable, dynamic post-graduate education through its conferences, certification programs, and on-site collaborations.

CMPS – Center for Modern Psychoanalytic Studies

Contact: Ron Okuaki Lieber
16 West 10th Street
New York, NY 10011
Phone: 212-260-7050
Email: director@cmps.edu
Website: www.cmps.edu

The Center for Modern Psychoanalytic Studies, a New York State licensure-qualifying institute chartered by the Board of Regents, was founded in 1971 to extend the theory and technique of psychoanalysis to include the treatment of the narcissistic disorders, furthering the pioneering work of Dr Hyman Spotnitz. Under the leadership of Dr. Phyllis W. Meadow the Center developed into one of the premier psychoanalytic training institutes in the country. Today, CMPS, led by its president Dr Mimi Crowell, is dedicated to maintaining the high caliber of its training program. Our program is open to clinicians and mental health workers in addition to those in the fields of education, the humanities, business, and the arts. Courses are designed to give students extensive exposure to the fundamentals of psychoanalysis as a theory of the mind, as a therapeutic method, and as

a scientific research tool. The clinical aspects include a fieldwork placement offering students the opportunity to observe severely regressed patients followed by a clinical studies internship at the Consultation and Referral Service where they treat psychoanalytic cases under supervision. For our graduates, CMPS opens new doors in understanding the underpinnings of emotional disorders while offering a unique and comprehensive approach to psychoanalytic technique.

ICP-LA Institute of Contemporary Psychoanalysis

Contact: Kathleen Burr
12121 Wilshire Blvd #505
Los Angeles, CA 90025-8441
Phone: 310-207-8441
Email: execdir@icpla.edu
Website: www.icpla.edu

The Institute of Contemporary Psychoanalysis was founded in 1991 by a group of senior psychoanalysts who saw the need for a new approach to psychoanalytic training. There are currently over 350 members, candidates and students at the Institute. ICP is a center for contemporary clinical training and research approached with a spirit of inquiry. We offer a full scope of psychoanalytic training to individuals with those personal, intellectual, and ethical qualities that make a good psychoanalyst. ICP welcomes candidates from a variety of disciplines who wish to obtain psychoanalytic training that incorporates the principles of academic freedom and participatory democracy.

Institute for Expressive Analysis (IEA)

Contact: Lynn Somerstein
150 East 84th Street, Suite 2P
New York, NY 10128
Phone: 212-861-6818
Email: dr.lynnsomerstein@gmail.com
Website: www.ieany.com

IEA is dedicated to the exploration and application of creativity in the processing and analysis of transference and resistance in depth oriented psychoanalytic treatment. We emphasize that therapy is a creative medium; it is crucial that Expressive Analysts have a thorough understanding of developmental, technical, and practical aspects of depth work. Our philosophy forms around the importance of non-verbal work and communications--starting by locating feelings in the body. It is rewarding that today neuropsychanalytic research and infant studies show that empathy is a body experience. We teach three main viewpoints: Object Relations, especially Winnicott; Jung; and Relational Theory.

ISPS–US

Contact: Karen Stern
P.O.Box 491
Narberth, PA 19072
Phone: 610–308–4744
Email: contact@isps-us.org
Website: www.isps-us.org

ISPS–US (The United States Chapter of The International Society for the Psychological treatments of the Schizophrenias and other psychoses) is an organization of mental health workers and interested others that was founded in 1998 by the late David B. Feinsilver. ISPS is an outgrowth of the International Symposia on the Psychotherapy of Schizophrenia, which has met triennially since 1956, and which was founded by Gaetano Benedetti and Christian Muller. We promote the appropriate use of psychotherapy in the treatment of schizophrenia, and further research and education in this area. We promote the humane, comprehensive and in–depth treatment of psychotic disorders. We reach across the boundaries of the mental health professions to integrate a psycho–bio–social approach. We host a lively and extremely informative listserv, and have active branches holding regular meetings in Baltimore/Washington, D.C., New York, Northern California, Southern California, New England, Chicago and Michigan (email list only) and we welcome new branches.

Jungian Psychoanalytic Association

Contact: Douglas Tompkins
9 W. 31st Street #18B
New York, NY 10001
Phone: 718–374–5120
Email: jpa@nyjung.org
Website: www.nyjung.org

The Jungian Psychoanalytic Association (JPA) of New York is an educational community of certified Jungian analysts, which follows the trajectory of C. G. Jung’s work as a theory of psychodynamics and the basis for effective analytic practice. The JPA seeks to promote and cultivate the continuing education and professional competence of its members. Members of the JPA also employ their experience in the training of prospective Jungian analysts, and participate in seminars and intensive colloquia offered by the JPA’s analytic training program. The JPA seeks to promote the creative understanding and applications of Jungian psychology in their contemporary conceptions in the larger professional, artistic, political, cultural, and scientific communities through research, conferences, and publications.

Massachusetts Institute for Psychoanalysis

Contact: Elizabeth Martin

288 Washington Street #343

Brookline, MA 02445-6850

Phone: 617.232.2777

Email: reachMIP@gmail.com

Website: [www. mipsa.org](http://www.mipsa.org)

The Massachusetts Institute for Psychoanalysis, Inc. offers a full program of psychoanalytic training for licensed mental health professionals. The program includes four years of courses in psychoanalytic technique and theories, as well as supervised psychoanalytic work. Faculty members are drawn from among the outstanding psychoanalytic teachers and supervisors in the Boston area as well as nationally. Applications are accepted on a rolling admissions basis with classes beginning in September. A special "advanced" candidates program is available for those clinicians (approximately ten years post-licensure) who have had significant experience conducting intensive, psychoanalytically-oriented treatment, been engaged in self-directed psychoanalytic study and personal analysis

Michigan Psychoanalytic Council

Contact: Murray Meisels

328 Thompson Street

Ann Arbor, MI 48104

Phone: 734-997-8833

Email: murrmeis@comcast.net

Website: www.mpcpsa.org

The MPC training program offers formal training in Child Psychoanalysis and Adult Psychoanalysis. A Psychoanalytic Psychotherapy training program is also offered. The Professional and Community Development program offers seminars, workshops and short courses for professional and personal development. The courses offered reflect the current heterogeneity of theory and practice in psychoanalysis, integrating developmental theories, trauma and affect theory, and newer models of women's psychology and development. MPC disavows any orthodoxy and welcomes all significant viewpoints in psychoanalysis.

MITPP, Metropolitan Institute for Training in Psychoanalytic Psychotherapy

Contact: Joyce Lerner

160 West 86th Street

New York, NY 10024

Phone: 212-496-2858

Email: mitppnyc@aol.com

Website: www.mitpp.org

MITPP, chartered by the New York State Board of Regents, offers three Certificate programs: a three year program in Psychoanalytic Psychotherapy with Adults, a two year program in Child and Adolescent Psychoanalytic Psychotherapy and a program for those with Masters Degrees who don't qualify for licensure in the established mental health professions which leads to New York State licensure in Psychoanalysis. Matriculants see patients at the affiliated Metropolitan Center for Mental Health. MITPP's low tuition of \$950 per semester includes both individual and group supervision. Courses are also offered on a non-matriculated basis. MITPP's three year program in Psychoanalytic Psychotherapy with Adults offers three years of advanced training in fundamental psychoanalytic theory, technique, and clinical practice. Throughout the training students examine and learn how to use their own responses to patients while they undertake supervised clinical work with a range of patients which permits them to experience what is being learned conceptually. Students study Freud's contributions, ego psychology, object relations theory and self psychology.

Northern Rockies Psychoanalytic Institute

Contact: Erna Smeets

612 West Main Street

Bozeman, MT 59715

Phone: 406-585-1302

Email: esmeets@nrpi.net

Website: www.nrpi.net

For NRPI the discoveries of Sigmund Freud maintain a core or primary position. Although our faculty finds itself more and more identifying as Freudian-Lacanian, the institute will facilitate candidates' exploration of other schools of thought. NRPI invites creative, self-starting and independent-thinking students, who will progress through psychoanalytic training at their own pace. Students may study here without applying for candidacy. NRPI welcomes distance learners "attending" via telephone. We have a number of students who study in this way with us. Distance learners who are accepted into candidacy must at that point travel to Bozeman a minimum of twice a year.

Northwest Center for Psychoanalysis in Seattle

Contact: Lisa Caldwell

PO Box 30533

Seattle, WA 98113

Phone: 206-624-0098

Email: ncpseattle@gmail.com

Website: www.ncpseattle.com

NPAP Training Institute

Contact: Doris Mare

40 W. 13th Street

New York, NY 10011

Phone: 212-924-7440

Email: info@npap.org

Website: www.npap.org

In 1948 NPAP became the pioneering institute for training people from diverse backgrounds for the profession of psychoanalysis. The Training Institute of NPAP evolved from seminars offered by Theodor Reik, who had studied with Sigmund Freud, and was an active proponent of psychoanalysis as a discipline separate from medical practice. The Training Institute of NPAP offers comprehensive psychoanalytic training that encompasses a range of theoretical orientations, including drive theory, ego psychology, object relations, self psychology, intersubjectivity, and relational perspectives. Our more than 350 members as well as our more than 100 candidates come from a broad range of backgrounds and disciplines, including the arts, literature, psychology, social work, the sciences, education, medicine, research, and more. People with rich cultural backgrounds and interests meet and study together in an atmosphere of collegiality and democracy. The Institute is chartered under the Education Law of the State of New York by the Board of Regents of the University of the State of New York. An Absolute Charter from the New York State Board of Regents was granted February 24, 1967. Our training program meets requirements for New York State licensure in psychoanalysis. Candidates begin their psychoanalytically-oriented practice with referrals from our Theodor Reik Consultation Center.

NPI Newport Psychoanalytic Institute

Contact: Penny Milner

250 West Main Street, Suite 202

Tustin, CA 92780-7724

Phone: 714-505-9080

Email: admin@npi.edu

Website: www.npi.edu

The Newport Psychoanalytic Institute was established in 1983 to promote the diverse theories and practices of psychoanalysis that have evolved from Freud to contemporary times. NPI is philosophically committed to the study of psychoanalytic theory and technique from all schools and traditions of psychoanalysis. Our training program offers a warm ambiance in small colloquiums with talented faculty. We seek to support a deep engagement together and in the work with our patients and to support the integration of theory, practice and self knowledge for each candidate. NPI presents programs to the psychologically interested public from the breadth of psychoanalytic, artistic and scientific thought. NPI is a free standing, non-profit educational institute with two campuses in California, Tustin and Pasadena. Both campuses offer programs leading to a Certificate in Dynamic Psychotherapy, a Certificate in Psychoanalysis, a Psy.D. in Psychoanalysis and a Ph.D. in Psychoanalysis

Toronto Institute for Contemporary Psychoanalysis

Contact: Brent Willock

14 Prince Arthur Avenue Suite 204

Toronto, Ontario M5R 1A9 Canada

Phone: 416-923-5252

Email: bwillock@rogers.com

Website: www.ticp.on.ca

The training program includes four years of weekly seminars, three supervised control cases, and three two-day workshops per year with distinguished visiting faculty. The Institute has a comparative-integrative philosophy. The curriculum aims to strike an optimal balance between professional training and scholarly education. Candidates learn to think critically and to formulate clinical material from different psychoanalytic points of view (particularly drive-structure, objects relations, and self psychology). There are currently twenty-four candidates in training.

PRESENTERS' BIOGRAPHIES

Eugene Alexander

San Francisco, CA

Gene Alexander is a poet, a playwright and a painter and has been practicing tai chi since 1990. He has a private practice in San Francisco, CA where he has been seeing families, couples and individual patients since 1976. His plays, *Illsa's Choice*, *The Weed Blossom*, and *Love for Beginners*, have been read at various theaters and conferences around the country.

Mildred Antonelli

New York, NY

Mildred Antonelli graduated in the '70's from a psychoanalytic institute that taught Interpersonal Theory. In 2007 she graduated from IPSS, where the emphasis was on Self Psychology and Intersubjectivity. As she has done over the course of her career she continues to work with children of all ages, adolescents and adults. In addition she now works with couples and families. She has supervised and taught at the graduate and undergraduate levels, and in private classes in Interpersonal Theory.

Samoan Barish

Sanata Monica, CA

Samoan Barish, Ph.D., is a Clinical Social Worker and psychoanalyst. Immediate past president of AAPCSW. Former Dean and current faculty at The Sanville Institute. Faculty Member at the New Center for Psychoanalysis in Los Angeles. Board Member of IFPE. Private Practice in Santa Monica, California.

Phillip Bennett

Philadelphia, PA

Phillip Bennett, Ph.D., is a psychologist and psychoanalyst in private practice in Philadelphia. He is the past President of the Philadelphia Society of Psychoanalytic Psychology, the local chapter of Division 39 (Psychoanalysis of the American Psychological Association). He is also a singer/songwriter and performs and records his and others' songs.

Sally Bjorklund

Seattle, WA

Sally Bjorklund is a psychoanalyst in private practice where she works with adults, couples and adolescents. She's interested in postmodern thinking on sexualities, gender and power, and the implication of psychoanalysis in these areas. She is involved with a new project to create a certificate program in relational psychoanalysis and psychotherapy. Given the requirement for living in the Pacific Northwest to be "outdoorsy," she likes to ski, kayak, sail, and hike.

B. William Brennan

Providence, RI

B. William Brennan, ThM, MA, LMHC is a psychoanalyst in Providence, RI. He is a graduate of the National Training Program of the National Institute for the Psychotherapies, NYC. He is past president of the Rhode Island Association for Psychoanalytic Psychologies, and an IFPE Board Member. He has published and presented nationally and internationally on Sándor Ferenczi, most recently *Ferenczi's Forgotten Messenger – the Life and Work of Izette de Forest* (2009).

Loren Buckner

Tampa, FL

Loren Buckner, LCSW is in private practice as a psychotherapist. She earned a MSW from Tulane University. Loren is a fellow at the International Psychotherapy Institute, a clinical supervisor in the China American Psychoanalytic Alliance, and a member of the Tampa Bay Psychoanalytic Society. She has spoken to parents locally, nationally, and internationally about the emotional challenges of raising children.

Sarah Chianese

New York, NY

Sarah Chianese is a Producer/Director and educator who has made it her life's mission to heal people through the arts by allowing them to explore their passions.

Rita Coufal

Santa Monica, CA

Rita Coufal, Psy.D., A.T.R.–B.C.,L.M.F.T., is an artist, art therapist and psychoanalyst in private practice in Santa Monica, California. She completed her psychoanalytic training at the Institute of Contemporary Psychoanalysis and served on the board of directors. Rita is also a clinical faculty member at Loyola Marymount University's Department of Marital and Family Therapy/Clinical Art Therapy.

Johanna Cuevas

Pasadena, CA

Johanna Cuevas, Ph.D Bilingual (Spanish) Clinical Psychologist, children and families. LAPAC member. Elementary School Teacher – LAUSD – Retired.

JoAnn Culbert–Koehn

Santa Monica, CA

JoAnn Culbert–Koehn, L.C.S.W., a Jungian analyst in private practice in Santa Monica, CA. is past President, previous Director of Training, and previous Co–Director of Children's Center at the Jung Institute of LA. Board member of Frances Tustin Memorial Trust, Exec. Committee Member of IAAP, publishes and lectures in U.S., Mexico, Europe.

Barry Dauphin

Ypsilanti, MI

Barry Dauphin is Associate Professor of Psychology and Director of Clinical Training at the University of Detroit Mercy. He is Chair of the IFPE Research Committee.

Caroline de Pottél

San Deigo, CA

Dr. de Pottél has been in private practice in San Diego for 30 years. She is affiliated with the San Diego Psychoanalytic Society & Institute and is a graduate of the psychotherapy and psychoanalytic programs and enjoys writing and presenting about her clinical work.

Maria do Rosario Dias

Lisbon, Portugal

Maria do Rosario Dias has a PhD in Clinical Psychology and a Master's degree in Educational Sciences from School of Psychology and Educational Sciences, University of Lisbon, Portugal. She is Associate Professor of Psychology at Institute of Health Sciences Egas Moniz, founded Egas Moniz – Multidisciplinary Research Center in Health Psychology, and is member of the Portuguese Association of Psychoanalysis and Psychoanalytic Psychotherapy.

Leanne Domash

New York, NY

I am very interested in helping patients develop their psychological creativity, that is, how to work through dysfunctional patterns to be open to the novel, invite surprise, tolerate paradox and seize opportunity in life. I am a Supervisor in the New York University Postdoctoral Program in Psychotherapy and Psychoanalysis and in private practice in New York, NY.

Mary Dougherty

Chicago, IL

Mary Dougherty, MFA, ATR, NCPsyA, is a Jungian psychoanalyst and art psychotherapist in private practice in Chicago. She is the current President of the C.G. Jung Institute of Chicago and former Director of Training. She is a contributing editor to the *Journal of Jungian Theory and Practice* and the *Journal of Analytical Psychology* with numerous articles published on analytical psychology.

Fang Duan

Mississauga, ON, Canada

Fang Duan is a PhD candidate in Education at York University, and a trainee with the Advanced Training Program of Psychoanalytic Psychotherapy Program. A student in literature, linguistics, and psychoanalysis, she is mainly interested in the use of psychoanalytical theory in reading literature for educational themes. Her research interests also include trauma studies, migration and exile, cultural theory and adult learning.

Peggy DuBois

Westlake Village, CA

Peggy DuBois is a practicing psychoanalyst in Westlake Village, California. She is a member of the Institute for Contemporary Psychoanalysis in Los Angeles, California. There she teaches classes and is a Senior Analyst. She is publishing personal letters between her mother and herself titled *A Woman of Dependent Meanings*.

Alexandra Freches Duque

Queluz, Portugal

Alexandra Duque is a Clinical Psychologist and holds a Master's degree in Psychology (Psychotherapy), from University of Lisbon. As a clinical psychologist she works with adolescent and adult patients, as well as Multiple Sclerosis Patients. She is also a teacher in the field of Health Communication and Health Psychology, and a researcher at Egas Moniz – Multidisciplinary Research Center in Health Psychology.

Fred Feirstein

New York, NY

Frederick Feirstein is a psychoanalyst in private practice and on the faculty of NPAP. *Gravity of the Black Hole* is his ninth book of poems and fourth verse play. It will be published in 2010 and was performed this year at the Medicine Show in New York. Fred has been a Guggenheim fellow and Pulitzer Prize finalist in poetry and has had a dozen plays produced, including *The Family Circle* which was published in Harper/Collins' Modern Classics Series.

Koby Frances

New York, NY

Koby Frances, Ph.D. is a Visiting Professor at the University of Indianapolis School of Psychological Sciences. He received his doctorate in clinical psychology from the City University of New York and has previously taught at the City College of New York and at Yeshiva University. His clinical and research interests are on sexual guilt, religious alienation, brief psychotherapy and psychosis.

Gerald J Gargiulo

Setauket, NY

Gerald J. Gargiulo is a former president of IFPE and of the Training Institute of The National Psychological Association for Psychoanalysis. A member of the American Psychoanalytic Association and the IPA, he has authored three books and over 90 articles; his latest book is *Broken Fathers/Broken Sons*. He is on the editorial boards of *Psychoanalytic Psychology* and *The Psychoanalytic Review*.

Volney P Gay

Nashville, TN

Volney Gay is Professor and Chair, Department of Religious Studies; Professor, Department of Psychiatry; Professor, Department of Anthropology, Vanderbilt University; on the Faculty, St. Louis Psychoanalytic Institute. He is Board Certified, American Psychoanalytic Association and a Supervising and Training Analyst. He is also Incoming-Director of Psychotherapy Training, Department of Psychiatry, Vanderbilt University School of Medicine. He has published eight books: *Freud on Ritual: Reconstruction and Critique* (1979), *Reading Freud: Neurosis, Psychology, Religion* (1983), *Reading Jung: Science, Psychology and Religion* (1984), *Understanding the Occult: Fragmentation and Repair of the Self* (1989), *Freud on Sublimation: Reconsiderations* (1992), *Joy and the Objects of Psychoanalysis* (2001), *Progress in the Humanities* (2009), *Neuroscience and Religion* (2009).

Meryle Gellman

Los Angeles, CA

Meryle Gellman Ph.D, Psy.D is a psychoanalyst in private practice in West Los Angeles. She specializes in a team approach to the psychotherapy of eating disorders, children of high conflict divorce, adolescent family therapy. She is a member and supervising analyst at the Institute of Contemporary Psychoanalysis in Los Angeles.

Oren Gozlan

Toronto, ON

Dr. Oren Gozlan, C. Psych is a psychoanalyst in private practice in Toronto. He served as adjunct faculty at Adler School of Professional Psychology and is currently a clinical director of a trauma clinic in Ontario.

Tamara McClintock Greenberg

San Francisco, CA

Tamara McClintock Greenberg, Psy.D., MS, Associate Clinical Professor of Psychiatry at UCSF. She is the author of *Psychodynamic Perspectives on Aging and Illness*.

Christina Griffin

Ventura, CA

Christina Griffin, Ph.D. is a psychologist in private practice where she divides her time between psychotherapy and forensic psychological assessment. She is a Candidate at the Institute for Contemporary Psychoanalysis and co-chair of IFPE's History of Psychoanalysis Committee.

Erica L Hill

Fort Lauderdale, FL

Dr. Hill graduated summa cum laude and Phi Beta Kappa from Gettysburg College and received her Ph.D. from Nova Southeastern University. She completed a two-year Fellowship through Harvard Medical School. She is in private practice in Fort Lauderdale, FL specializing in helping individuals and their families with trauma, diabetes, and ADHD and learning disabilities.

Meghan Hinman

Brooklyn, NY

Meghan Hinman, LCAT, MT-BC is a licensed creative arts therapist and board-certified music therapist currently practicing in New York City. She has worked in a variety of medical inpatient settings and currently operates a private music psychotherapy practice. She specializes in work with grief and bereavement, and sexuality.

Peter T Hoffer

Secane, PA

Peter T. Hoffer, Ph. D. is Professor of German at the University of the Sciences in Philadelphia and a Fellowship Associate member of the Psychoanalytic Center of Philadelphia. He is co-translator (with Axel Hoffer) of Sigmund Freud's *Phylogenetic Fantasy: Overview of the Transference Neuroses* and translator of the three-volume *Correspondence of Sigmund Freud and Sandor Ferenczi*, as well as the author of several published papers on Ferenczi and the history of psychoanalysis.

Montana Katz

New York, NY

Montana Katz, Ph.D., LP is a training and supervising psychoanalyst and on the faculty at The National Psychological Association for Psychoanalysis and at The National Institute for the Psychotherapies. She is on the editorial boards of *The Psychoanalytic Review* and *Psychoanalytic Inquiry*. Montana Katz has a private practice in New York City and in Greenwich, CT.

Katherine Knowlton

Seattle, WA

Katherine Knowlton is a Seattle psychologist with a private practice doing psychoanalytically informed long-term therapy with adults. She leads Balint groups for third year residents in Family Medicine at the University of Washington, and for physicians new to practice at a private multi-specialty clinic. She serves on the national council of the American Balint Society.

Ryan Lamothe

St Meinrad, IN

Ryan LaMothe is professor of pastoral care and counseling at Saint Meinrad School of Theology. He is a fellow in AAPC and a Diplomate in the American Psychotherapy Association. Ryan has over 90 publications and three books in the areas of psychoanalysis and pastoral care and counseling.

Sara Lavner

New York, NY

Sara Lavner, drama therapist and psychoanalyst has a private practice in Greenwich Village in New York City. She is on the Board of The Institute for Expressive Analysis. She has done workshops for other Institutes and for businesses. Sara is a professional actress who has performed in TV, film and theatre. Her performances range from *The Muppets Take Manhattan* to David Mamet's play *Sexual Perversity In Chicago*.

Ruth Litjmaer

New Jersey, NJ

Ruth M. Lijtmaer, PhD, is a senior supervisor, training analyst and faculty at The Center for Psychotherapy and Psychoanalysis of New Jersey and in private practice in Ridgewood, NJ. She has done paper presentations and lectures, both nationally and internationally. She also published several articles on multicultural issues, transference and countertransference.

Elizabeth Lunbeck

Nashville, TN

Elizabeth Lunbeck is the Nelson Tyrone, Jr. Professor of History and Professor of Psychiatry at Vanderbilt University. She is the author of *The Psychiatric Persuasion: Knowledge, Gender, and Power in Modern America* and, with Bennett Simon, of *Family Romance, Family Secrets: Case Notes from an American Psychoanalysis, 1912*, and editor of a number of volumes. She is currently completing *The Americanization of Narcissism*.

William MacGillivray

Knoxville, TN

Bill MacGillivray is a clinical psychologist in private practice in Knoxville, TN, past president of the Appalachian Psychoanalytic Society, editor of *Psychologist-Psychoanalyst*, and president elect of the Division of Psychoanalysis of the American Psychological Association

Bart Magee

San Francisco, CA

Bart Magee, Ph.D. (Chair) Executive Director of Access Institute for Psychological Services, a San Francisco clinic serving low-income patients and providing psychoanalytic internship training.

Douglas F Maxwell

New York, NY

President of IFPE, Past President of NAAP, Senior member, training analyst and faculty of NPAP, Member and Faculty of IEA, Arts Editor of the *Psychoanalytic Review*, and Adjunct Assistant Professor of Arts at NYU.

Marilyn McCabe

Nashville, TN

Marilyn McCabe is a psychologist in private practice in Nashville, TN and is active in the Nashville Psychoanalytic Study Group. She completed her doctorate at the University of Southern California and a fellowship with Hans Strupp at Vanderbilt. There, she became interested in psychotherapy research. She is the author of *The Paradox of Loss: Toward a Relational Theory of Grief*.

Jon Mills

Ajax, ON, Canada

Jon Mills, Psy.D., Ph.D., ABPP is a philosopher, psychologist, and psychoanalyst in private practice in Ajax, Ontario, Canada. He is a Diplomate in Psychoanalysis and Clinical Psychology with the American Board of Professional Psychology and was founding president of the Section on Psychoanalysis of the Canadian Psychological Association. He is the author of many works in psychoanalysis and philosophy including 11 books, most recently, *Origins: On the Genesis of Psychic Reality*. He received a Gradiva Award in 2006 for his scholarship presented by the National Association for the Advancement of Psychoanalysis in New York City.

Gershon J Molad

Tel Aviv, Israel

Gershon J. Molad, M.A. is a clinical psychologist in private practice in Tel Aviv, Israel. He teaches at the Tel Aviv University Program of Psychotherapy, at the University of Haifa Program of Advanced Studies in Psychotherapy, and with the Autobiographical Dialogue Seminars (with Judith Vida).

Merle Molofsky

New York, NY

Merle Molofsky is a psychoanalyst in private practice in NYC; IFPE board member; Advisory Board, Harlem Family Institute; co-editor, IFPE on-line journal *Other/Wise*; editorial board member, *The Psychoanalytic Review*; and member of NPAP, IEA and HFI. Her play, *Kool-Aid*, was produced at Lincoln Center, and her poetry has been published in various venues. She has taken energy healing trainings with Robert Jokel and Larry LeShan.

Karola Mostafanejad

Geraldton, Australia

Karola Mostafanejad is a full-time PhD candidate with her thesis close to submission. She was previously the Head of the School of Nursing at Central West TAFE in Geraldton, Western Australia, and adjunct teaching fellow at the School of Nursing and Midwifery, Curtin University, Perth. She lectured in mental health at diploma and degree levels and her research interests are in mental health. She has published in the International Journal of Mental Health Nursing.

Ruth Neubauer

Denver, CO

After almost thirty years in psychoanalytic psychotherapy practice, supervising young professionals, teaching on the faculty of The Washington School of Psychiatry in DC, I have a passion for the core concepts which define and describe psychoanalytic thinking and practice. Being a writer, musician, and photographer helps me teach the analytic concepts in an interdisciplinary way – with particular interest in the general public.

Leanh Nguyen

New York, NY

Leanh Nguyen has been involved over the past 10 years in human rights work as a clinician, advocate, and expert witness for victims of torture and persecution. A former director of clinical training at the Bellevue/NYU Program for Survivors of Torture, she is now in private practice in NYC and is an advanced candidate at NYU Postdoctoral Program for Psychoanalysis.

Josie Oppenheim

New York, NY

Josie Oppenheim MA, NCPsyA, LP, was co-founder and Director of the Stella Adler Conservatory Theater and has published numerous articles on creative development and early childhood education. She lectures widely on psychoanalytic and cultural subjects and is a recipient of the Phyllis W. Meadow Award for Excellence in Psychoanalytic Writing. She is in private practice in New York City.

Stuart D Perlman

Los Angeles, LA

Dr. Perlman is a psychologist in private practice in WLA, and a training analyst at the Institute of Contemporary Psychoanalysis. He has published many articles in psychoanalytic journals and authored the book, *The Therapist's Emotional Survival: Dealing With The Pain Of Exploring Trauma*, which was a Psychotherapy Book Club Main Selection. He is also painting portraits, and showing and selling his art.

Nicole Poliquin

Los Angeles, CA

Nicole Poliquin, MD is a psychiatrist and a psychoanalyst by training. She practices in West Los Angeles and Costa Mesa California and specializes in difficult to treat cases, involving mood issues and personality disorders as well as addiction. She and Dr. Gellman have been collaborating for several years in the treatment of patients who present unusual challenges. They have an ongoing dialogue about this type of therapeutic arrangement.

Richard Raubolt

Ada, MI

Richard Raubolt Ph.D. Board Member of IFPE, Chair of Publications Committee, Co-Editor of *Other/Wise* and author of *Theaters of Trauma*.

Thomas Robatham

Boston, MA

Thomas Robatham is an accomplished artist, consulting director at BU Center for Digital Imaging Arts, an inventor and lighting designer, Instructor in Filmmaking and Cinematographer, Director of Photography at International Cinematographer's Guild and supporter of Porter Smith's vision.

Alan Roland

New York, NY

Practicing psychoanalyst, Greenwich Village. Member, Faculty and Board of Directors, National Psychological Association for Psychoanalysis. Faculty, Institute for Expressive Analysis. Author, over 50 articles, three books and one forthcoming, and editor and contributor, four books. Exhibiting artist.

Rachel Ryan

Oak Ridge, TN

Rachel Ryan (MAAT), an artist and art therapist, has most recently worked with adults with substance use disorders, at-risk youth, and elderly adults. She is a recent graduate of the Master of Arts in Art Therapy program at the School of the Art Institute of Chicago and a member of the American Art Therapy Association (Illinois and Tennessee state chapters).

Cecile Generaux Schwedes

Westlake Village, CA

Cecile Generaux Schwedes, M.A., M.F.T. has been in private practice for over 20 years in West Los Angeles and Westlake Village working with individuals and couples both adults and teenagers. She is a continuing education provider training clinicians and giving workshops. As adjunct faculty since 1989, Cecile continues to teach several courses in the graduate Marriage and Family Counseling and School Psychology programs including Couples Counseling, Family Therapy, Child Counseling, Group Counseling, Abnormal Developmental Psychology and the four core practicum courses.

Julius Seeman

Nashville, TN

Jules Seeman is one of the earliest representatives of the humanistic-experiential movement. He is the recipient of numerous honors, including the APA Carl Rogers Award. Dr. Seeman spent six years with Carl Rogers at the University of Chicago and the next 37 at Peabody College, Vanderbilt University. His latest publication is *Psychotherapy and the Fully Functioning Person*.

Vance R Sherwood

Knoxville, TN

Dr. Sherwood is a clinical psychologist in private practice in Knoxville, Tennessee. He is the author of numerous articles and three books, including *Becoming a Constant Object for the Borderline Patient in Psychotherapy* and *Psychotherapy of the Quiet Borderline*, both co-authored with Charles P. Cohen, and *Getting Past Resistance: Psychotherapy with the Out of Control Adolescent*.

Farrell Silverberg

Philadelphia, PA

Farrell Silverberg, PhD, NCPsyA, is a clinical psychologist, a Supervising psychoanalyst at the Philadelphia School of Psychoanalysis, and the first Western student of Taopsychotherapy master Rhee Dongshik in Korea. Silverberg has lectured internationally and published in the United States and Asia on psychoanalysis and Eastern thought including *Resonance and Exchange in Contemplative Psychotherapy* (2008).

Ken Silvestro

Seeley Lake, MT

Kenneth Silvestro received a PhD in the field of Artificial Intelligence. He then attended the C. G. Jung Institute. Currently, he is a faculty member in the graduate program with Capella University and the undergraduate program with Union Institute & University.

John T Sloma

Middletown, NY

John Sloma, psychoanalyst, Board Certified in Clinical Social Work, in New York Metropolitan area. He has extensive training in role theory and psychodrama. He completed his analytic training at NPAP. A presenter on Freud, Moreno, and Gandhi, he appeared in an Anger Management Documentary for MTV. His 2008 presentation, *Love and Fear in the Analytic Encounter*, was well received at the IFPE Conference in Boston.

Porter Smith

Hartsdale, NY

Porter Smith is an accomplished Composer and musician afflicted with the disease of bi-polar disorder.

Lynn Somerstein

New York, NY

Lynn Somerstein, PhD, RYT, member IFPE, NPAP, NAAP, IAYT, is the Director of the Institute for Expressive Analysis, book review editor of the *Psychoanalytic Review*, yoga teacher at Integral Yoga Institute, and psychoanalyst in private practice.

Marilyn Stickle

McLean, VA

Marilyn Stickle, Ph.D., LCSW, has been a board member of the Greater Washington Society for Clinical Social Work, The Clinical Social Work Institute (CSWI), and the Society for Spirituality and Social Work. In private practice in Arlington, Virginia for over 35 years she has been a faculty member of CSWI, a seminar and meditation group leader, and has presented papers nationally and internationally.

Janet Sullivan

New York, NY

Janet Sullivan, psychoanalyst, music therapist, and singer maintains an eclectic practice in Manhattan and is a Senior Creative Arts Therapist at Gracie Square Hospital. Board and Faculty member and mentor at The Institute for Expressive Analysis, she also graduated from IEA. She has presented at both music therapy and psychoanalytic conferences and has published in Group. She utilizes EMDR, yoga and breathing in her practice.

Stefanie Teitelbaum

New York, NY

Stefanie Teitelbaum, LCSW, Certified Psychoanalyst is a graduate of NPAP, Training Analyst, Supervisor and Faculty Member at NPAP and IEA. She is the author of articles published in the *American Journal of Psychoanalysis* and the *Psychoanalytic Review*, and a contributing author to the *Blanton-Peale Encyclopedia of Psychology and Religion*, and the *Edinburgh Dictionary of Psychoanalysis*. Stefanie is a graduate of the Juilliard School where she majored in Voice and Opera Theatre.

Susan Thau

Santa Monica, CA

Susan Thau, Ph. D. is a supervising and training analyst in the Institute of Contemporary Psychoanalysis. Dr. Thau has been a long term member of Allan Schore's study group and is interested in the integration of neuropsychology and attachment as they enhance the process of treatment for individuals and couples. She has also had advanced training in Emotionally Focused Therapy for couples (Susan Johnson).

Dai To

Moraga, CA

Dai To, Ph.D. clinical psychologist at Avenal State Prison and clinical supervisor at Mills College.

Judith E Vida

Sunland, CA

Judith E. Vida, M.D. is a Past President of IFPE, currently Membership Chair and Member at Large of the Board of Directors. She is one of 12 Founders of the Institute of Contemporary Psychoanalysis, Los Angeles. Longstanding interlocking interests in the history of psychoanalysis, Sandor Ferenczi, contemporary art, and the autobiographical inform both her writing and her private practice in Los Angeles, CA.

Judith Viorst

Washington, DC

Judith Viorst, a graduate of the Washington Psychoanalytic Institute, has written children's books (including the best-selling *Alexander and the Terrible, Horrible, No Good, Very Bad Day*), adult fiction and non-fiction (including the best-selling *Necessary Losses*), books of poetry (including her latest, *Unexpectedly Eighty*) and three musicals. She is married to political writer Milton Viorst and has three children and eight grandchildren.

Les Von Losberg

Sleepy Hollow, NY

Les Von Losberg has been a poet, song writer, and conceptual artist for more than forty years. He has published poetry in small press literary magazines and exhibited his artwork at the Katonah Museum. He has been a member of IFPE since 2001. He works as an estate, and business insurance and retirement planner.

Gail R Yardley

Tarzana, CA

Gail R. Yardley, Ph.D. is a clinical psychologist and candidate at the Institute of Contemporary Psychoanalysis, Los Angeles, California. She has a private practice in Tarzana and Santa Monica, California.